

BUILT ENVIRONMENT



# HIGHER CERTIFICATE IN ARCHITECTURAL TECHNOLOGY

South Africa's  
only SACAP validated  
Higher Certificate in  
Architectural  
Technology



**INSCAPE**



## COURSE INTRODUCTION

Inscape is the only institution to offer a registered and accredited Higher Certificate in Architectural Technology that has been validated by the South African Council for the Architectural Profession (SACAP).

The programme is a **one-year full-time contact or two-year part-time distance learning programme**. The programme equips **students with practical knowledge and skills for the job market and includes work-integrated learning to prepare them for real-world work experiences**. The certificate acts as a **access opportunity for students to work towards higher qualifications** in Architecture, Mechanical Engineering, Civil Engineering, Urban Design, Project Management and Design. Students pursuing further studies must meet the institution's entrance requirements.

## COURSE OVERVIEW

- **Introduces students to technical drawing, design basics and sustainable design principles, enabling them to develop ethical and socially responsible solutions.**
- **Familiarises students with architectural drawing**, construction techniques, building terminology, materials and finishes, model construction, architectural periods and styles.
- **Learn business basics including project management and professional practice management** for architectural technologists and how to start a business.

## FOCUS AREAS

- Technical Drawing Practices
- Design Fundamentals
- Green and Sustainable Technology
- Professional Practice Management
- Project and Business Practices
- Software Application
- Experiential Training



# SUBJECTS



- Technical Drawing Practices
- Design Fundamentals
- Green and Sustainable Technology
- Business and Practice Management
- Software Application for the Built Environment
- Experiential Training 240 Hours

*Software training includes AutoCAD and Revit*

SACAP has granted Inscope unconditional validation status for the Higher Certificate in Architectural Technology (NQF level 5).

## Registration Process:

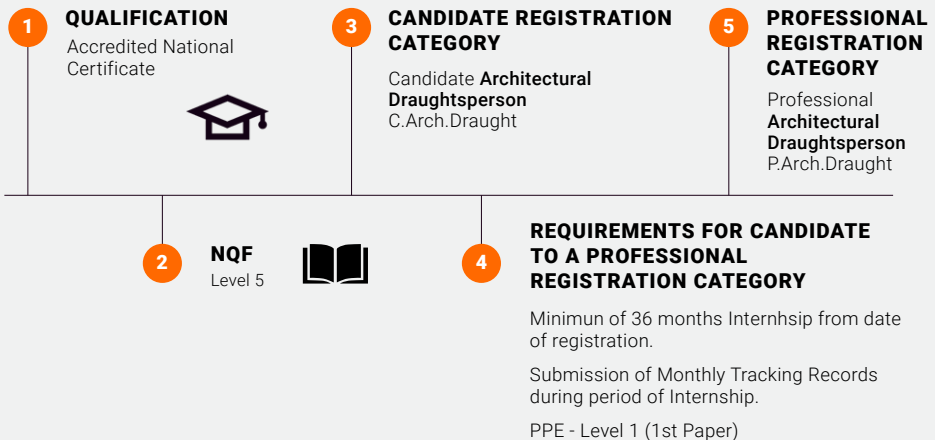

# COURSE STRUCTURE



## CONTACT LEARNING

- ✓ 1 year full time
- ✓ NQF level 5
- ✓ 8 x 1h 45 min sessions per week
- ✓ Approximately 2.5 hours additional independent study per session
- ✓ Continuous project-based assessment
- ✓ 240 hours of Experiential Training to be completed.

## DISTANCE LEARNING

- ✓ 2 years part time
- ✓ NQF Level 5
- ✓ Enrolments in March, July and November
- ✓ 240 hours of Experiential Training to be completed
- ✓ Continuous project-based assessment

- Subjects are broken down into modules to facilitate online learning over the two years.
- Courseware and assessments provided to the student on the Inscape LMS.
- Feedback from a qualified assessor is provided on each assessment.
- Students are provided with support on their learning journey as well as support regarding library, technical, administrative and financial queries.

## ARTICULATION OPTIONS

Students who have graduated with the Higher Certificate in Design Techniques may apply for the Degree at Inscape if they have an average of over 60%, or for a Diploma if they have passed with an average over 50%. Graduates may qualify for Diploma or Degree in a related Design field. Institutional minimum requirements will apply.



SAQA ID: 97623 | NQF 5  
**1 YEAR CONTACT LEARNING**  
**2 YEARS DISTANCE LEARNING**



# ENTRY REQUIREMENTS

South Africa	Special Admissions	International Qualifications
<p>Candidates must have completed a National Senior Certificate (NSC).</p> <p>If you have any queries regarding the process, please email - <a href="mailto:applications@inscape.co.za">applications@inscape.co.za</a></p>	<p><b>Mature age exemption</b> Candidates over the age of 45 who did not complete Matric may qualify for mature age exemption.</p> <p>Please contact the Registrar for additional information <a href="mailto:registrar@inscape.co.za">registrar@inscape.co.za</a></p> <p><b>RPL</b> If the candidate has a NQF level 3 qualification, but has design industry experience, they may qualify for entry via Recognition of Prior Learning (RPL).</p> <p>In order to be considered for entry via RPL the candidate should have a minimum of two years industry experience.</p> <p>The RPL process is used to evaluate the learning that candidates with existing industry experience may have gained and would need to be substantiated with relevant supporting documents.</p> <p>Please contact the Registrar for additional information <a href="mailto:registrar@inscape.co.za">registrar@inscape.co.za</a></p>	<p>If the candidate has a foreign qualification, for admissions to a Higher Certificate, they must apply to South African Qualifications Authority (SAQA) for a National Senior Certificate NQF level 4 equivalence.</p> <p>International candidates must be competent in English at and equivalent level to NQF 4.</p> <p>All international students attending contact classes require a study permit in the name of Inscape Education Group valid for the duration of the chosen course.</p> <p>Please contact the Registrar for additional information <a href="mailto:registrar@inscape.co.za">registrar@inscape.co.za</a></p>

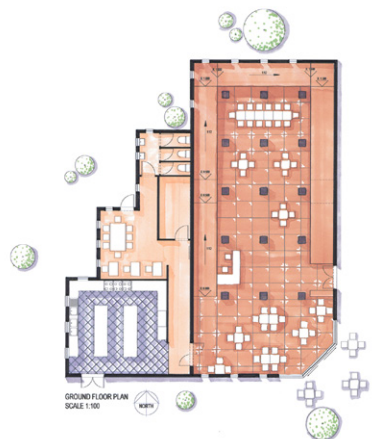

# LEARNING HUBS



## CAPE TOWN

1st Floor, 17 Salt River Road SALT RIVER



## DURBAN

641 Peter Mokaba Ridge, MORNINGSID



## MIDRAND

353 Alexandra Road, HALFWAY GARDENS



## PRETORIA

193 Corobay Avenue, WATERKLOOF GLEN



## STELLENBOSCH

Bosman's Business Centre, 1 Distillery Road,  
Stellenbosch Central, STELLENBOSCH

## APPLICATIONS

Phone (+27) 861 467 2273

Fax: (+27) 86 409 1627

[applications@inscape.co.za](mailto:applications@inscape.co.za)

## CENTRAL

PostNet Suite 104, Private Bag X19,  
Menlo Park, 0102, SOUTH AFRICA

**INSCAPE**  
APPLY NOW | [INSCAPE.AC](https://www.inscape.ac)

### REGISTRATION AND ACCREDITATION

Inscape Education Group (Pty) Ltd is registered with the Department of Higher Education and training as a Private Higher Education Institution under the Higher Education Act, 1997 (reg no. 2000/HE07/002). Established in 1981. Company Reg: 2002/028979/07. VAT Reg: not applicable. Directors: HL Bührs and ME Schoeman.